

TAROS NEO

HR Priručnik za instalaciju i servis

Kuhinjska slavina



A

Tap Taros Neo Swivel Top HP SS

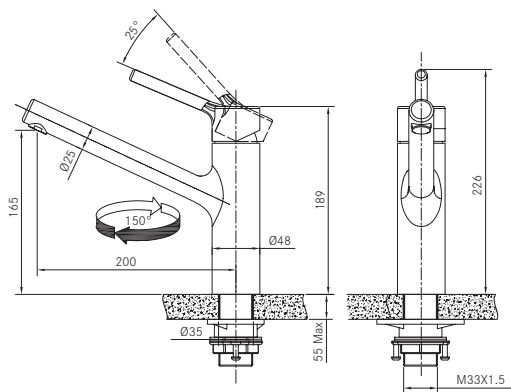
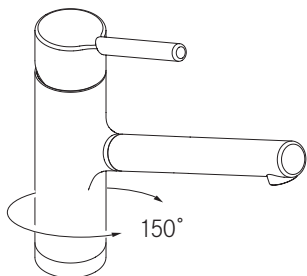

B

Tap Taros Neo Pull Out Nozzle Top HP SS

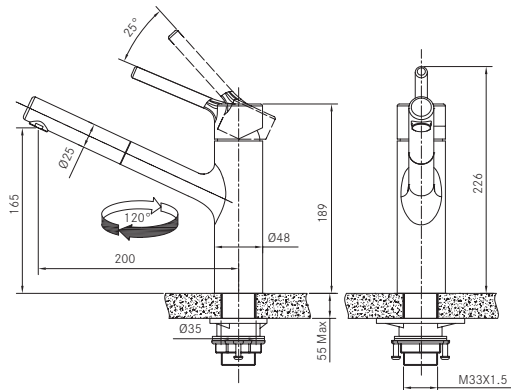
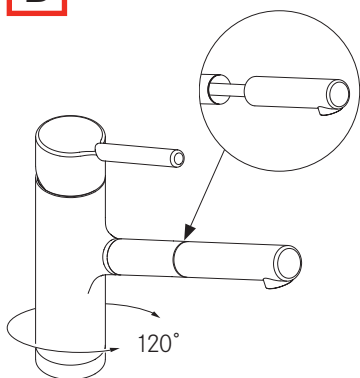

C

Tap Taros Neo Pull Out Spray Top HP SS

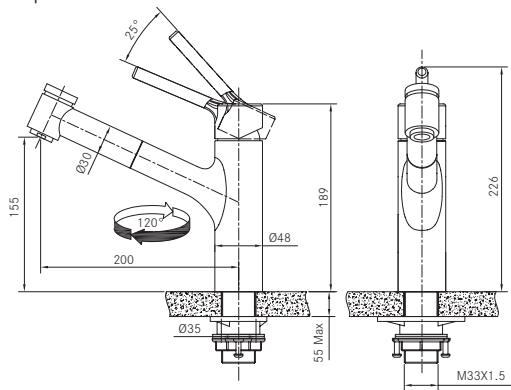
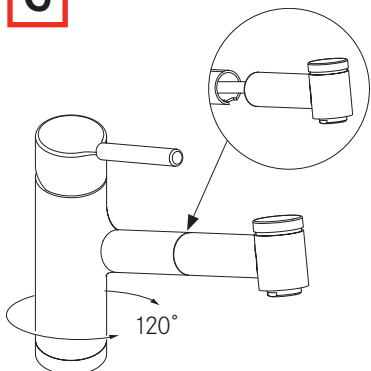

D Tap Taros Neo Swivel Top HP Window SS

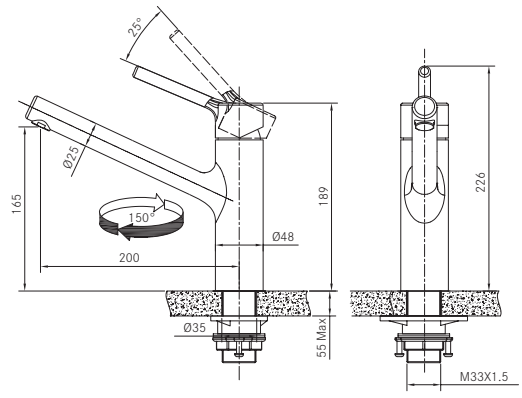
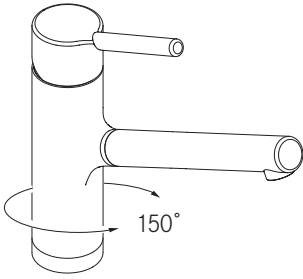

E Tap Taros Neo Pull Out Nozzle Top HP Window SS

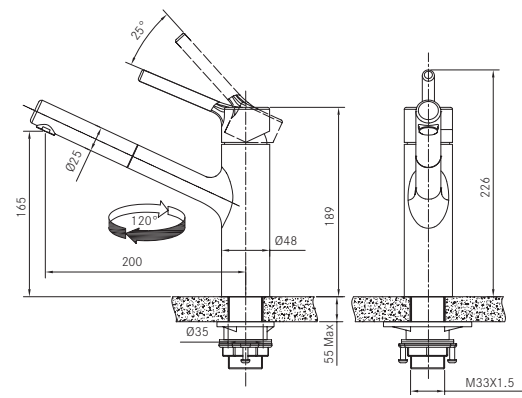
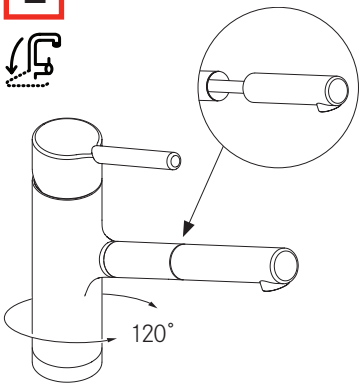

F Tap Taros Neo Swivel Top LP Window SS

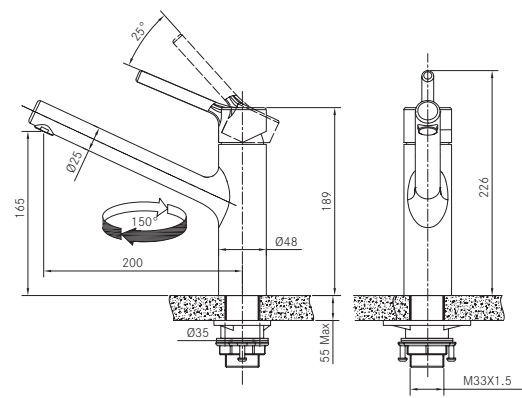
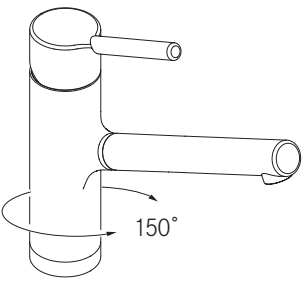

G Tap Taros Neo Pull Out Nozzle Top LP Window SS

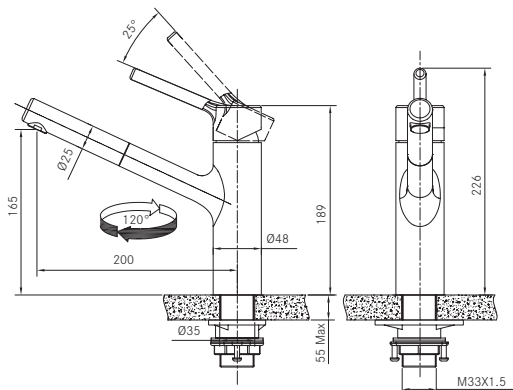
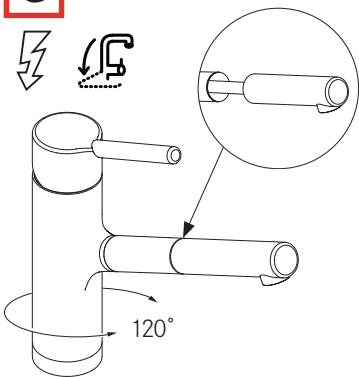

i **C**

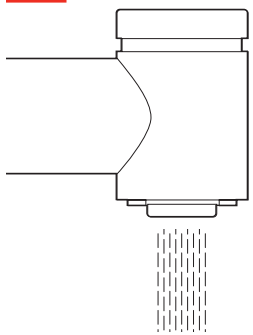

Hand icon

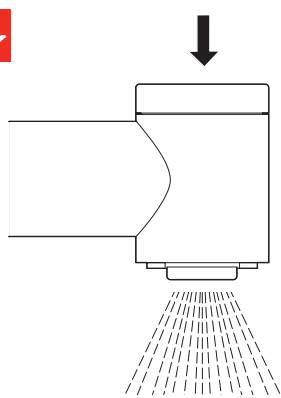

i **D** **E** **F** **G**

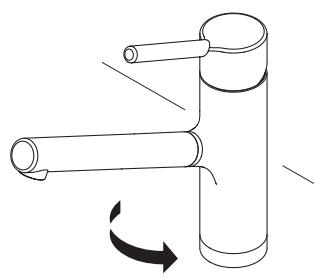

Hand icon

Warning icon

>65 mm

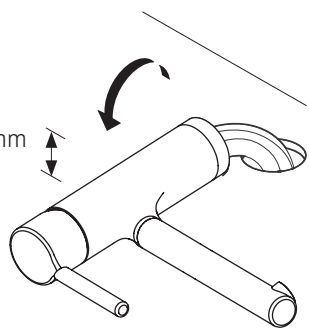

i F

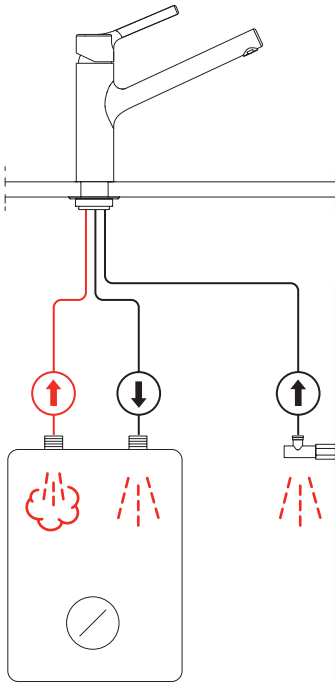

i G

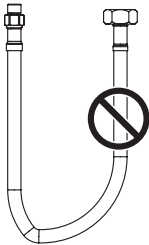
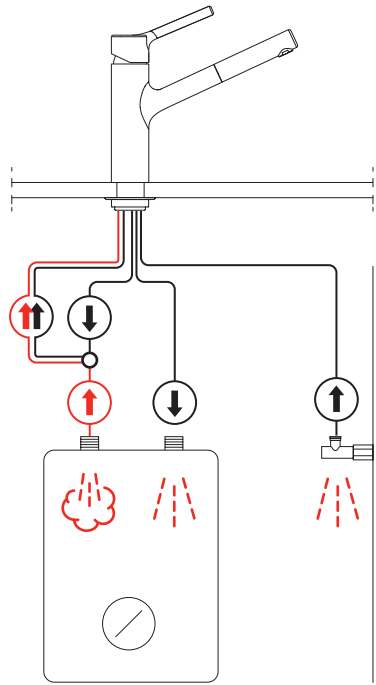



1



ø35 mm

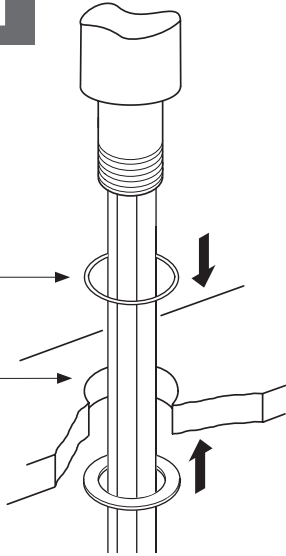

2



7 Nm

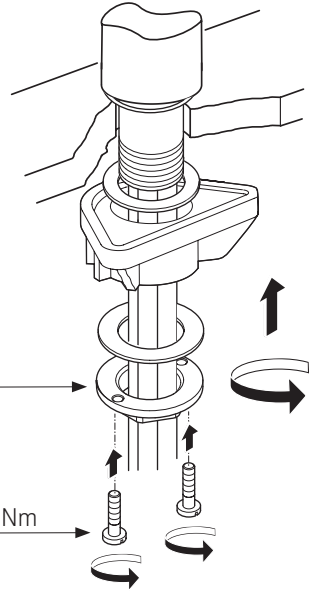

3

A

D

$R_{max} \geq 50mm$



19 mm
UK: 23 mm

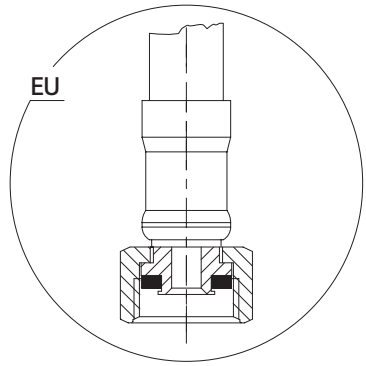
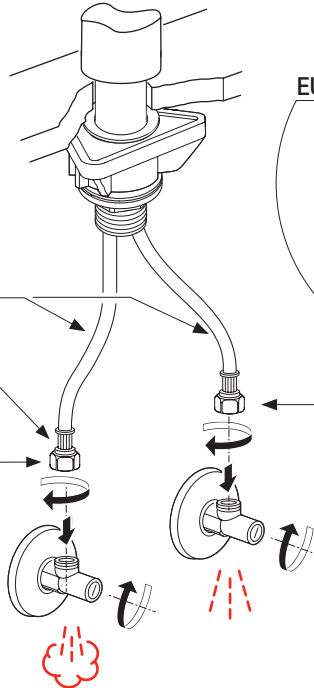

3

F

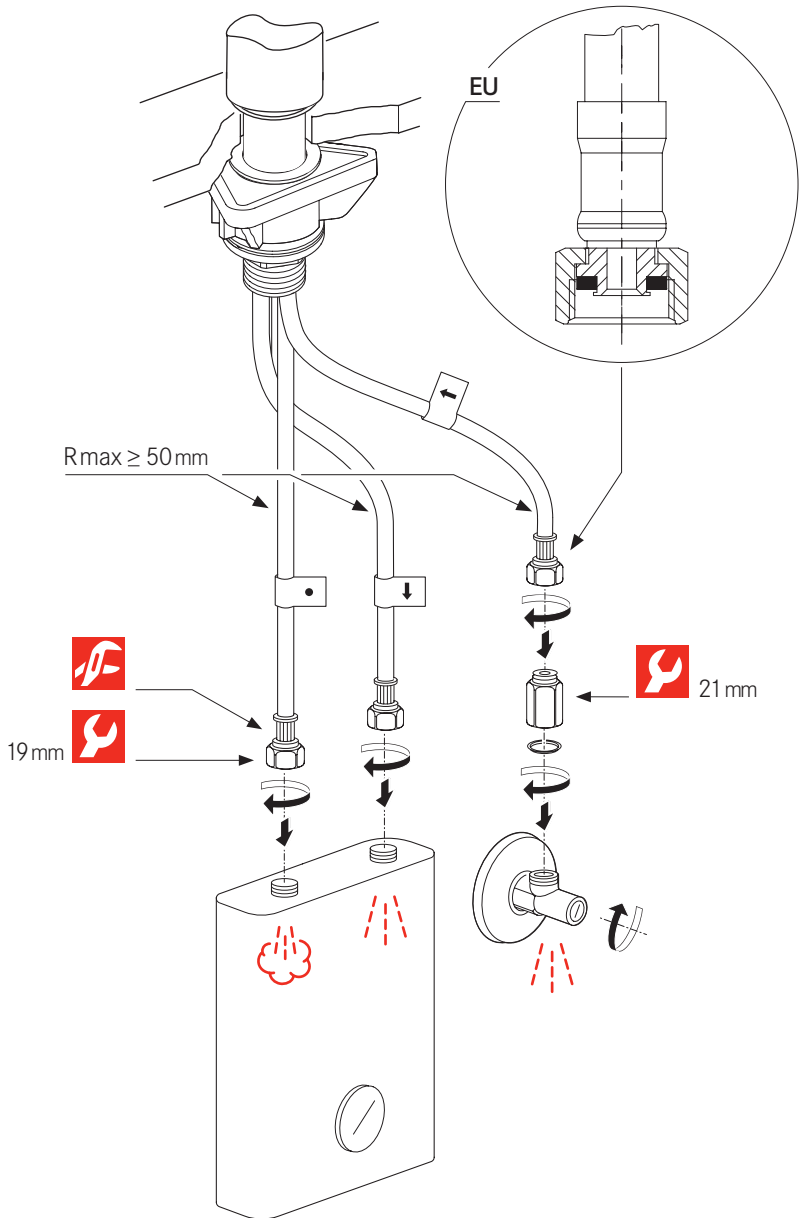

3

G

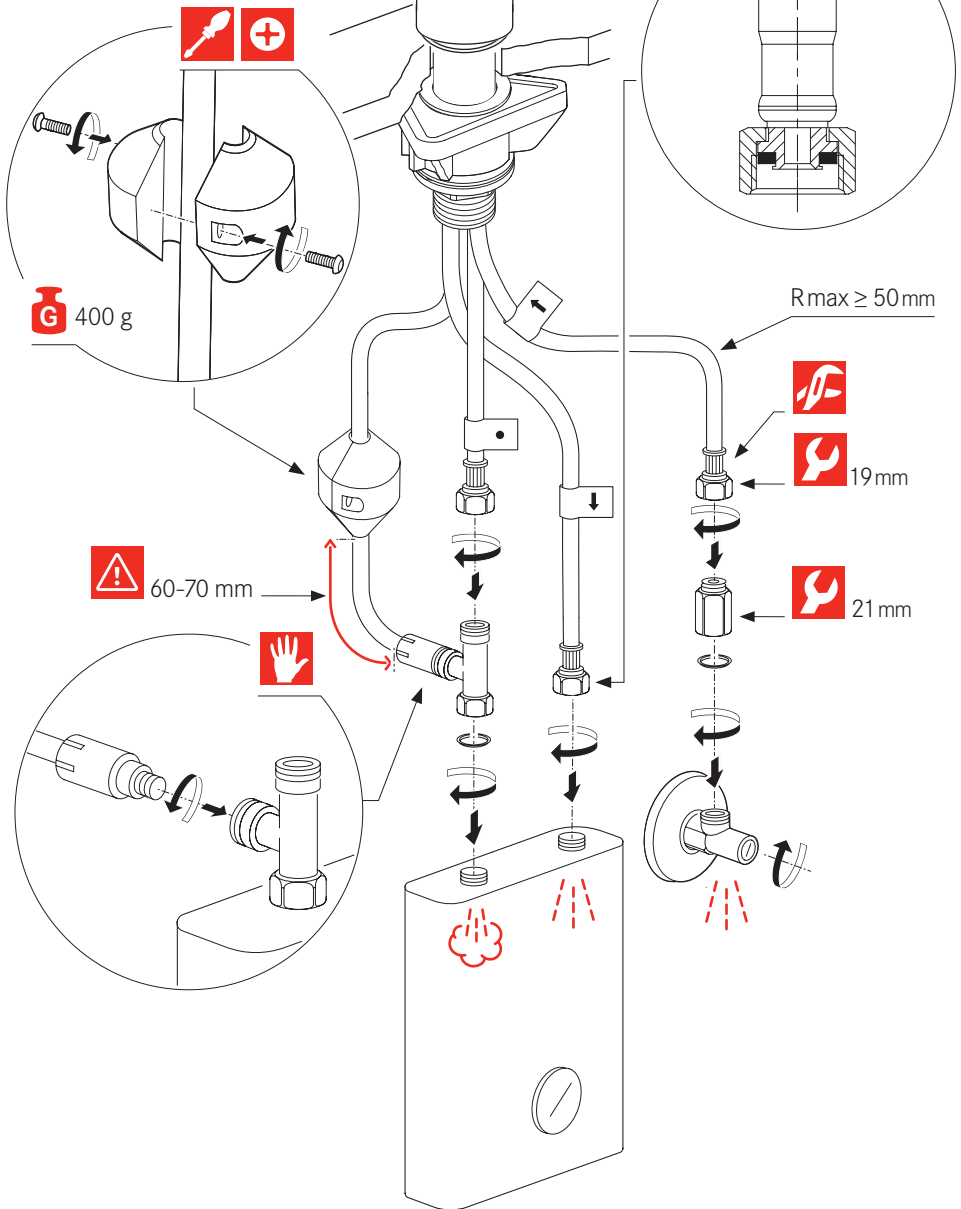

4

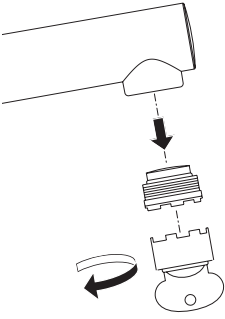

5

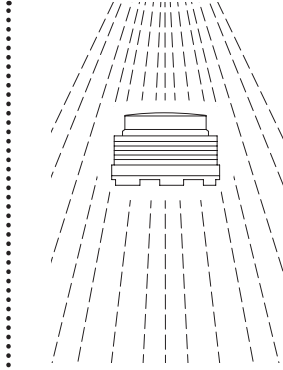

6

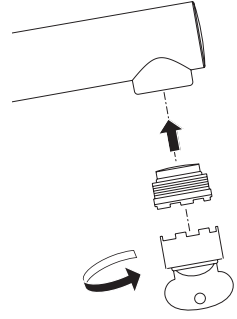

4

C

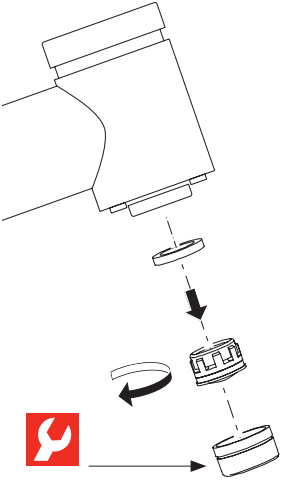

5

C

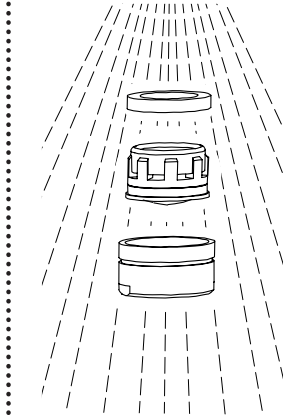

6

C

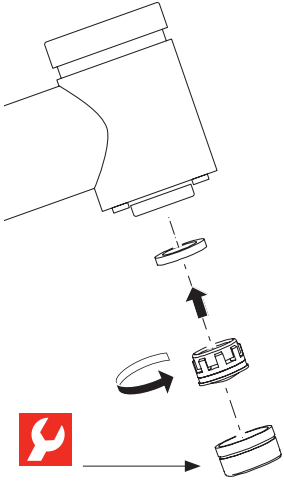

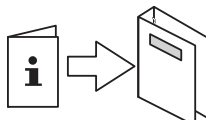
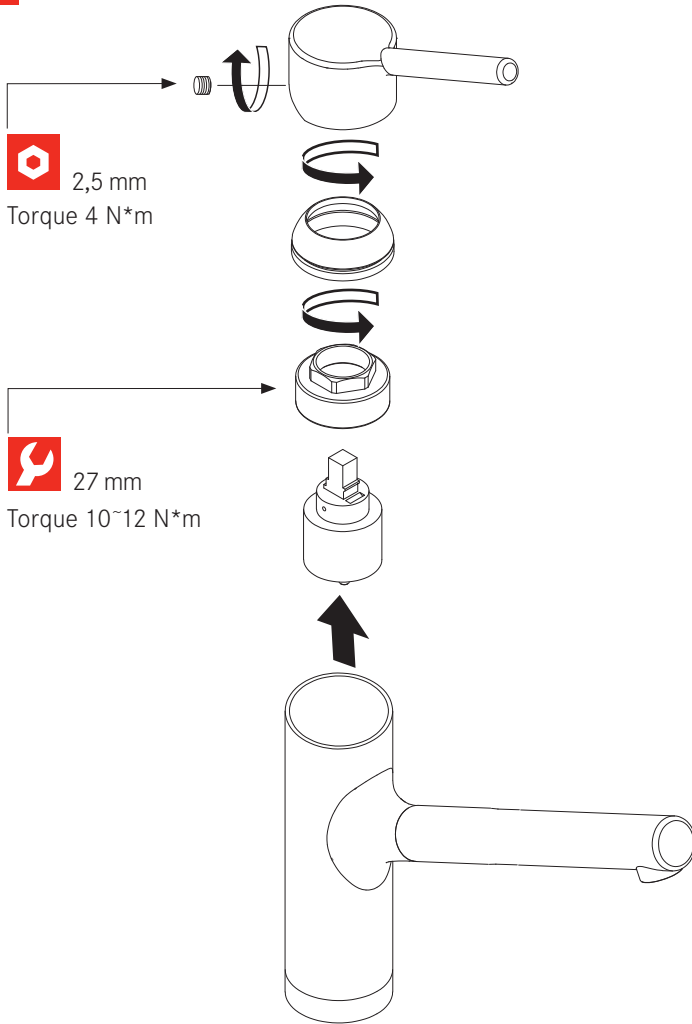

www.franke.com



Povremene provjere

- ▶ Povremeno provjerite spoj i crijeva za tuševe s obzirom na sljedeće:
 - Vodonepropusnost
 - Korozija
 - Mehanička oštećenja
- ▶ Upotrebjavajte samo originalne rezervne dijelove.
- ▶ Zamijenite crijeva koja su vlažna ili cure.
- ▶ Zamijenite crijeva s hrdavim ili oksidiranim površinama.
- ▶ Zamijenite crijeva koja pokazuju znakove mehaničkog oštećenja.



- ▶ Prije instalacije temeljito isperite sve cijevi.

Radni podaci	Vrijednost		
Radni tlak (idealni)	3 bar	45 PSI	300 kPa
Radni tlak (maks.)*	5 bar	70 PSI	500 kPa
Radni tlak (min.)*	1 bar	14,5 PSI	100 kPa
Temperatura vode (idealna)	60 °C	140 °F	
Temperatura vode (maks.)	70 °C	158 °F	

* Preporučuje se jednak tlak.

**A**

Tap Taros Neo Swivel Top HP SS

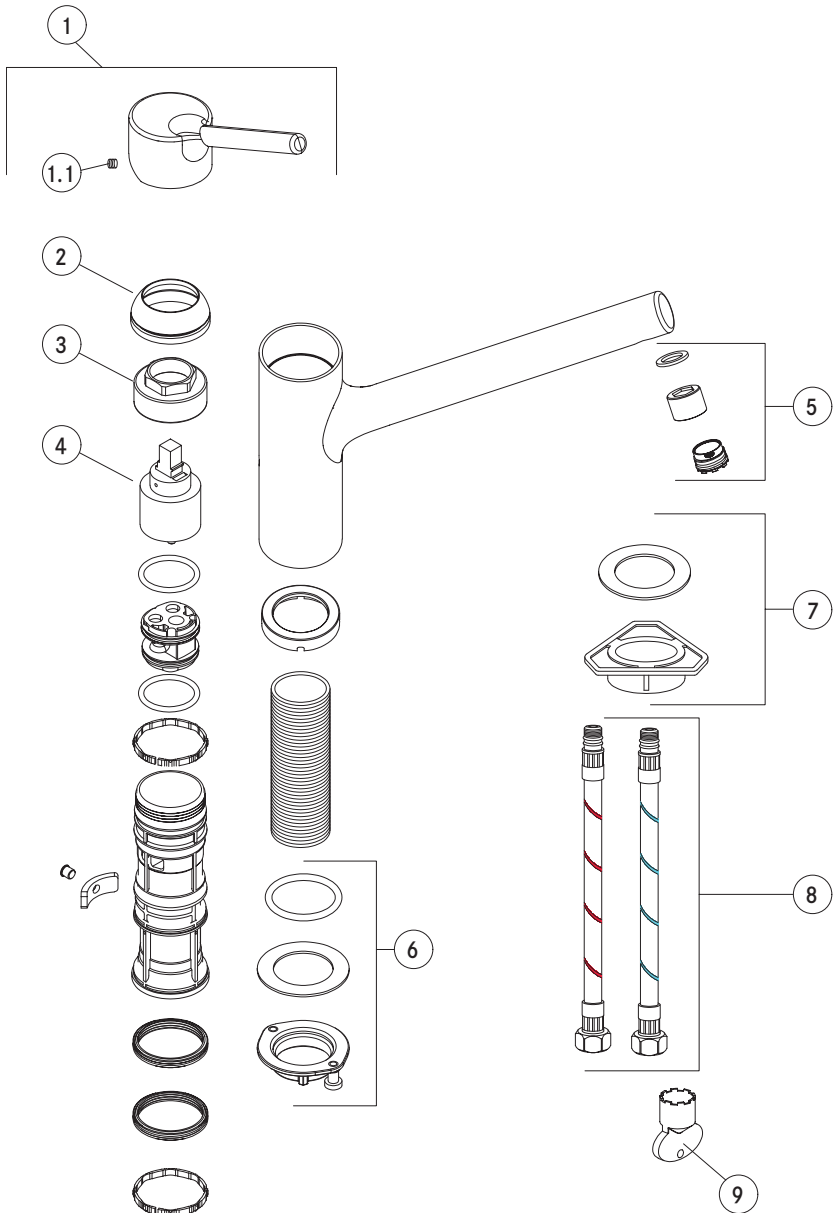

B Tap Taros Neo Pull Out Nozzle Top HP SS

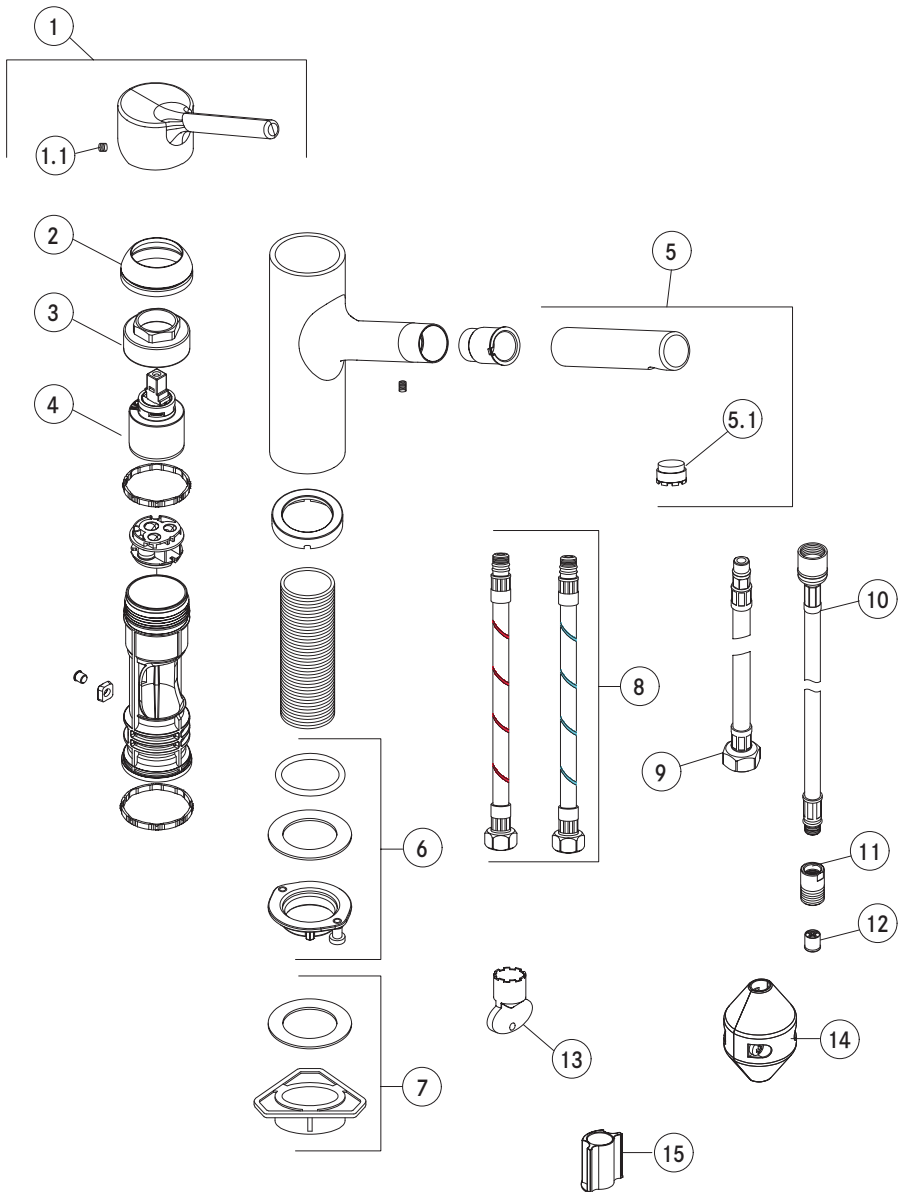

C Tap Taros Neo Pull Out Spray Top HP SS

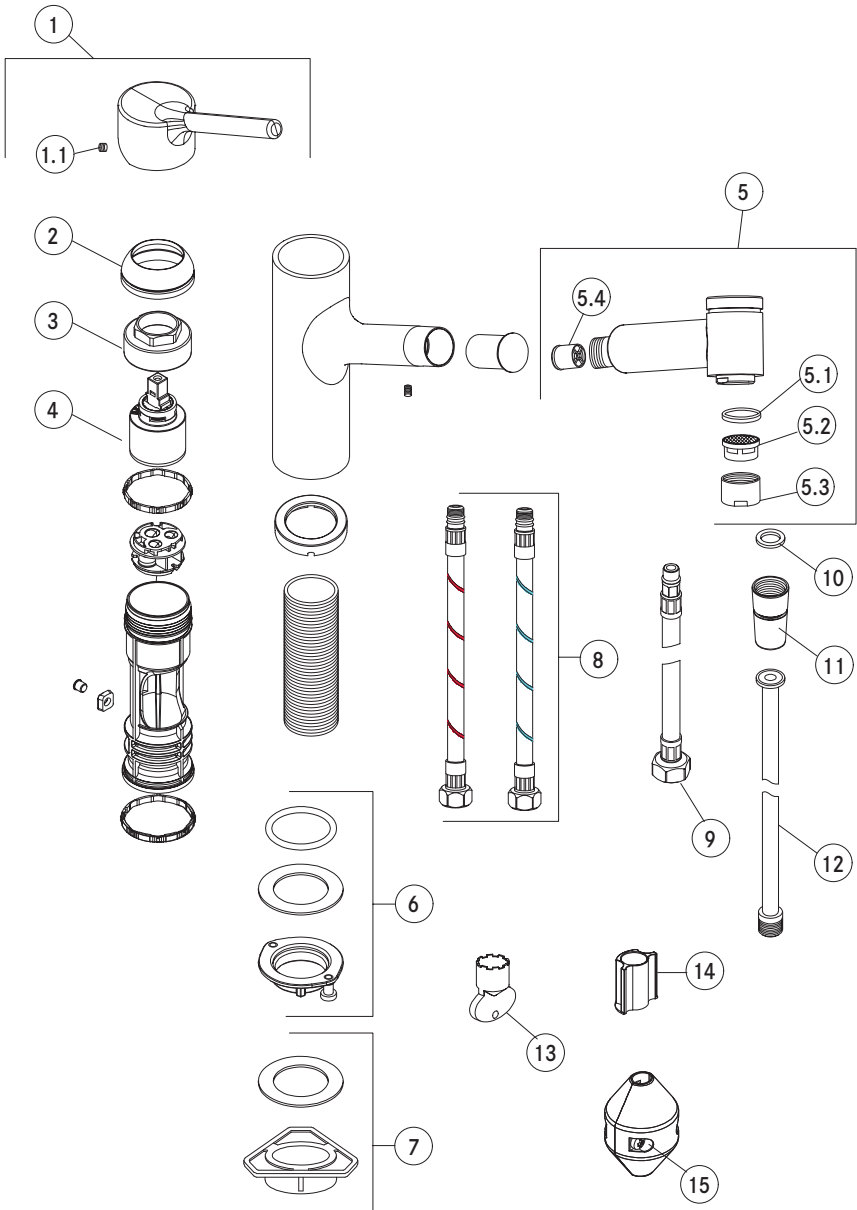

D Tap Taros Neo Swivel Top HP Window SS

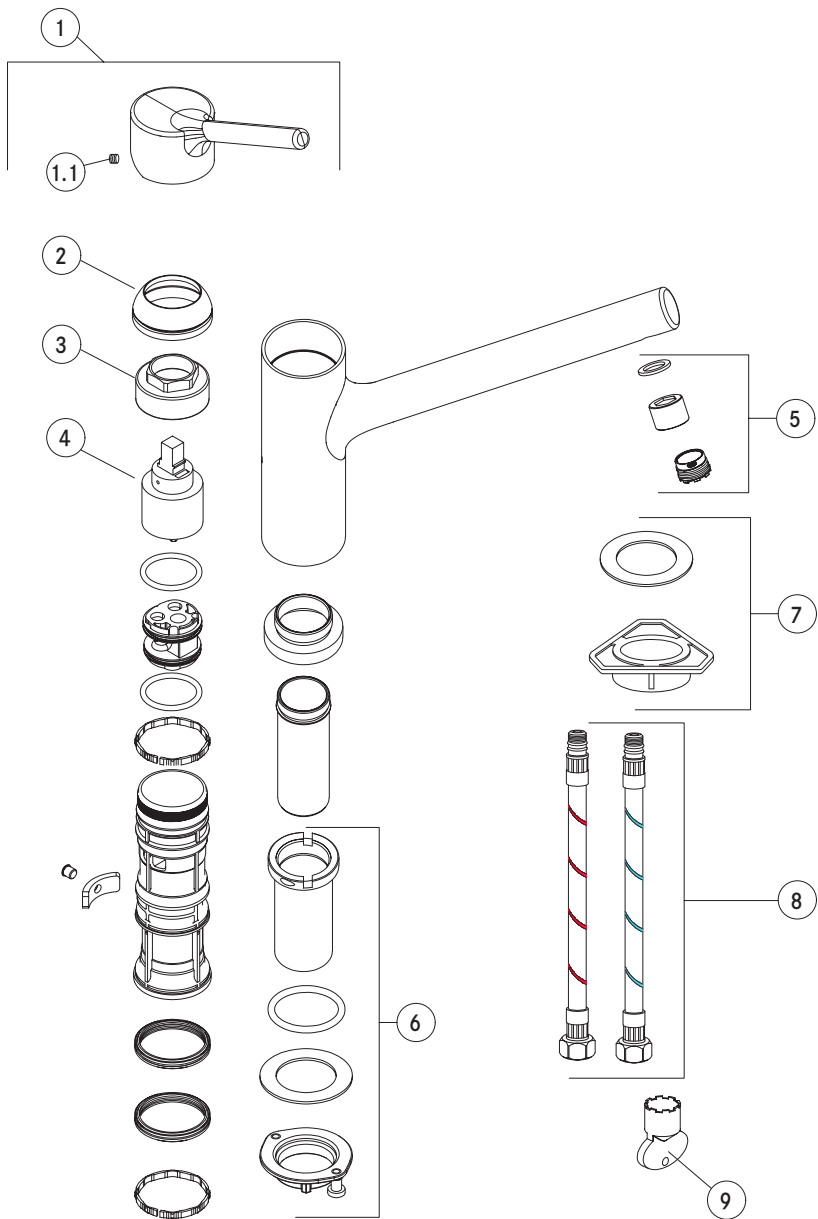

E Tap Taros Neo Pull Out Nozzle Top HP Window SS

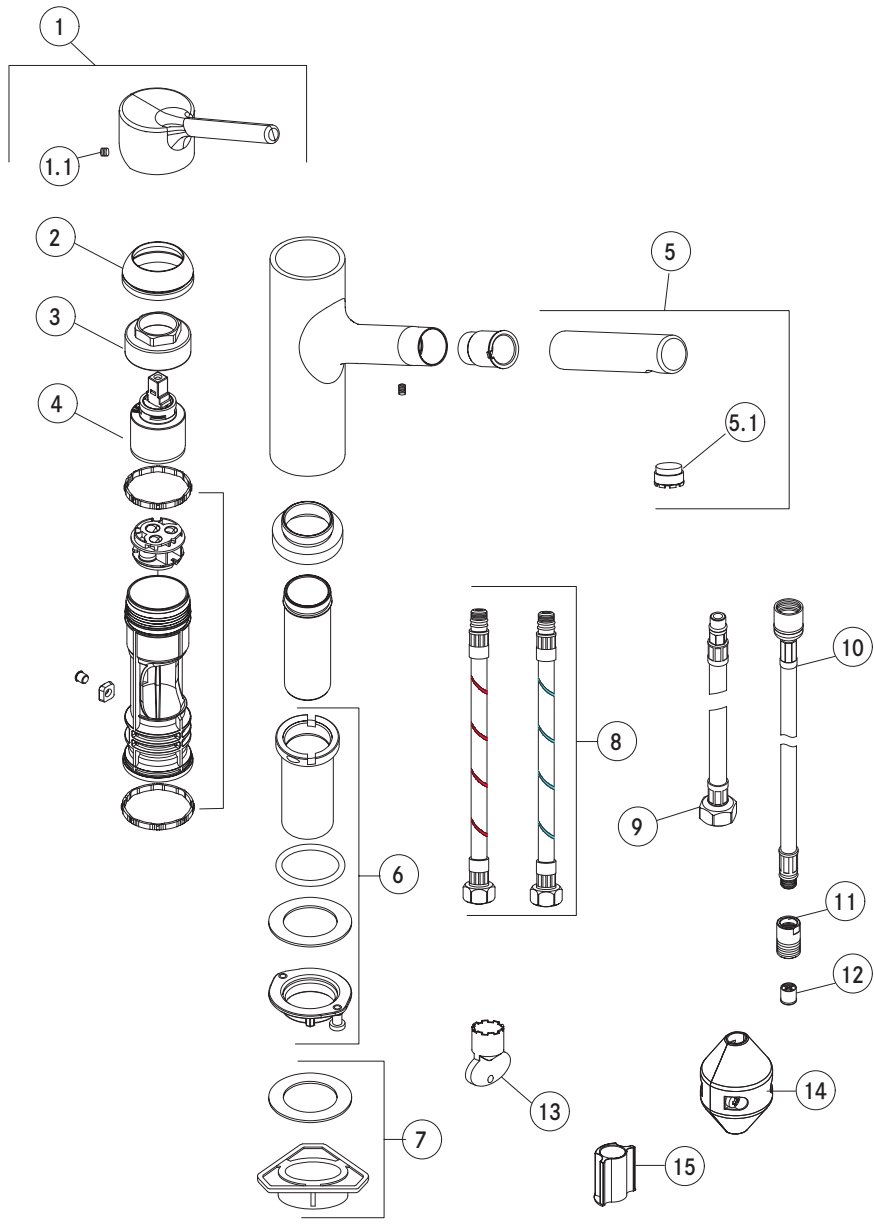

F Tap Taros Neo Swivel Top LP Window SS

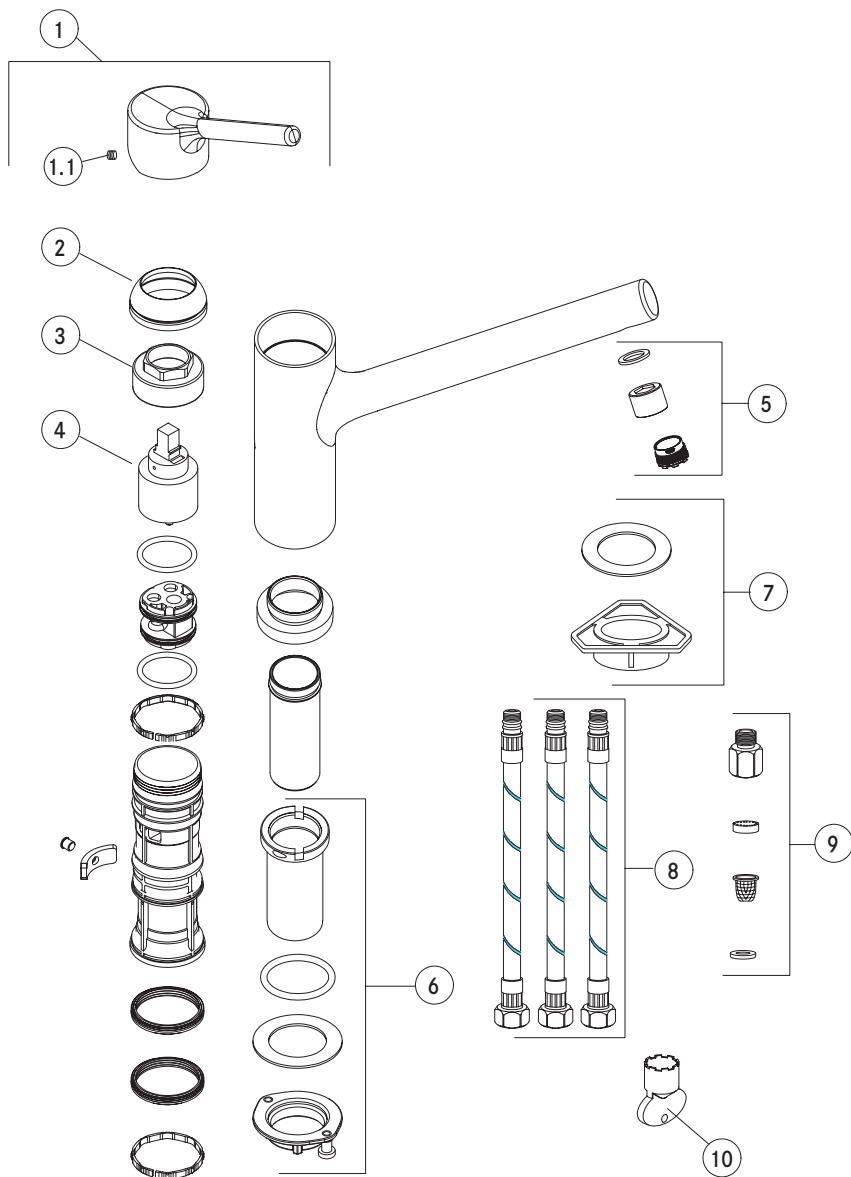

G Tap Taros Neo Pull Out Nozzle Top LP Window SS

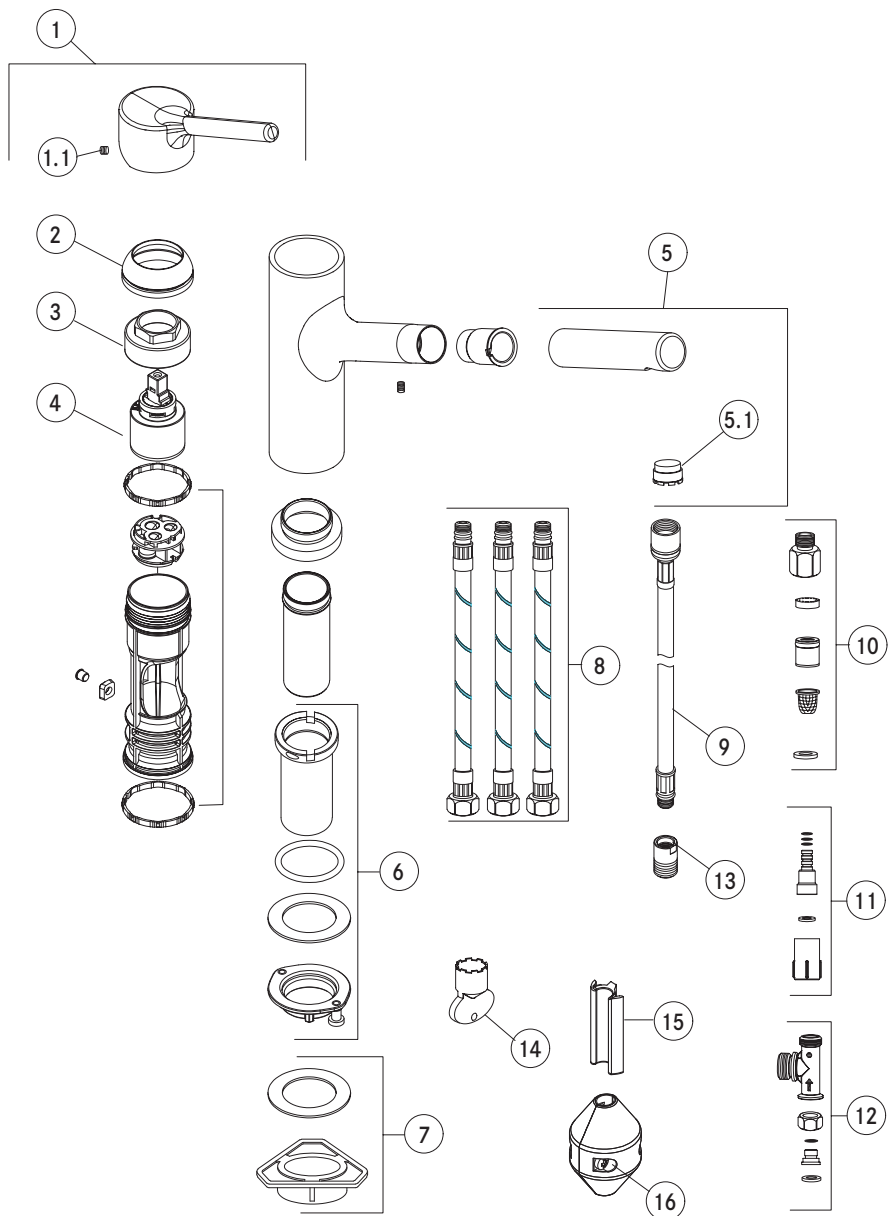

Gemma B&D d.o.o.

Uvoznik i distributer za RH
10000 Zagreb, Prisavlje 2

Veleprodaja:

tel.: 00385 1 6196 446, 6195 604

fax: 00385 1 6195 581

e-mail: veleprodaja@gemma.hr

Centralni servis:

tel/fax: 00385 1 6195 582

e-mail: servis@gemma.hr

www.gemma.hr

Gemma BH d.o.o.

Uvoznik i distributer za BiH
71210 Sarajevo, Trešnje 1
(naselje Doglodi - Iliđa)

Veleprodaja:

tel./fax: 00387 33 775 472,

00387 33 775 473

e-mail: info@gemma.ba

www.gemma.ba

**Gemma B&D d.s.d.
Podgorica**

Uvoznik i distributer za CG
81000 Podgorica, Serdara Jola
Piletića bb (PC Palada)

Veleprodaja:

tel.: 00382 20 672 961

e-mail: veleprodaja@gemmabd.me

www.gemmabd.me

Radi stalnog poboljšavanja proizvoda može doći do promjene tehničkih podataka bez prethodne obavijesti. Ove upute napravljene su s mnogo truda i s najvećom pažnjom, no pogreške u procesu izrade i/ili prijevoda uputa uvijek su moguće. Stoga proizvođač i prodavatelj ne preuzimaju odgovornost za eventualne netočne navode, pogreške u prijevodu ili tiskarske pogreške u ovim uputama.